

FHDQI35 Floor Stand

Assembly SOP



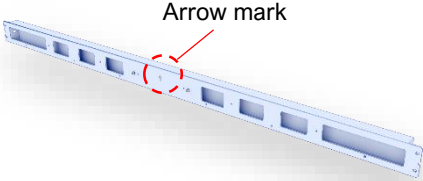
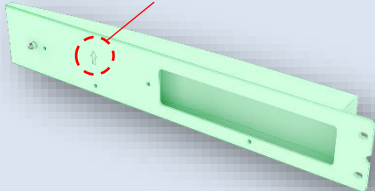

FHDQ135 Floor Stand Parts List

FHDQ135 Floor Stand Parts List (1/4)

Item	Parts Name	Image	Quantity	Note
1	Vertical column module		2 PCS	<ul style="list-style-type: none"> Provides the vertical structure to mount the main beams and provides rollers for the stand.
2	Main support beam		2 PCS	<ul style="list-style-type: none"> Provides a horizontal structure between the 2 vertical column assemblies and provides an attachment surface for the mount bars. When assembling this part, its arrow mark must face the top side.
3	Left wing beam		2 PCS	<ul style="list-style-type: none"> Provides an extension of the main beams on the left side. When assembling this part, its arrow mark must face the top side.

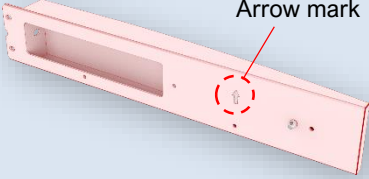
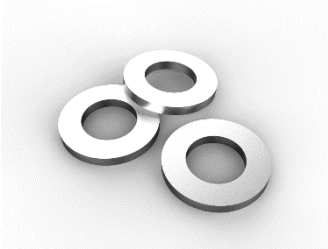
FHDQ135 Floor Stand Parts List (2/4)

Item	Parts Name	Image	Quantity	Note
4	Right wing beam		2 PCS	<ul style="list-style-type: none"> Provides an extension of the main beams on the right side. When assembling this part, its arrow mark must face the top side.
5	M8 flat Washers		8 PCS	<ul style="list-style-type: none"> Appearance feature: There are One round holes.
6	M8 x 12 socket head screw		8 PCS	<ul style="list-style-type: none"> Attaches vertical column to main beams and wings, M8x12 socket head screw.

FHDQ135 Floor Stand Parts List (3/4)

Item	Parts Name	Image	Quantity	Note
7	M4x10 flat head screw		16 PCS	<ul style="list-style-type: none"> Attaches vertical column to main beams and wings, M4x10 flat head screw.
8	M6 x 20 socket head screw w/ lock and flat washer		12 PCS	<ul style="list-style-type: none"> Attaches mount bars to rolling floor stand.
9	Plus large M6 flat washer		12 PCS	<ul style="list-style-type: none"> Attaches mount bars to rolling floor stand.

FHDQ135 Floor Stand Parts List (4/4)

Item	Parts Name	Image	Quantity	Note
10	5mm Allen wrench tools		1 PCS	<ul style="list-style-type: none">For disassembly & assembly of M6*12 screws.

Pre-work for Assembling Floor Stand

Pre-work for Assembling Floor Stand

Preparation matters

- Number of engineering personnel : **at least two.**
- Tools and equipment needed :
 1. 6 mm & 5 mm Allen wrench tools.
 2. Phillips screwdriver.
 3. Platform with dimensions of at least **2300 * 1600 * 580 mm.**

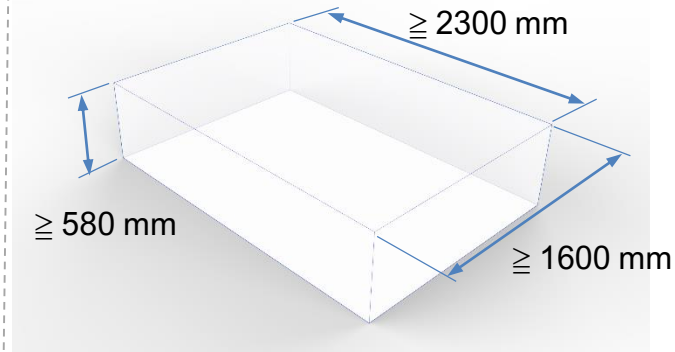

Pre-work for Assembling Floor Stand

Assembling the mount bar of FHDQ135

- Assemble two pieces of FHDQ135 mount bar.
- Fixed assembled mount bar using M5 x 10 PHMS.

Step. 1

- Locate the left and right mount bar and place them on a flat surface as shown. Slide together engaging alignment pins.

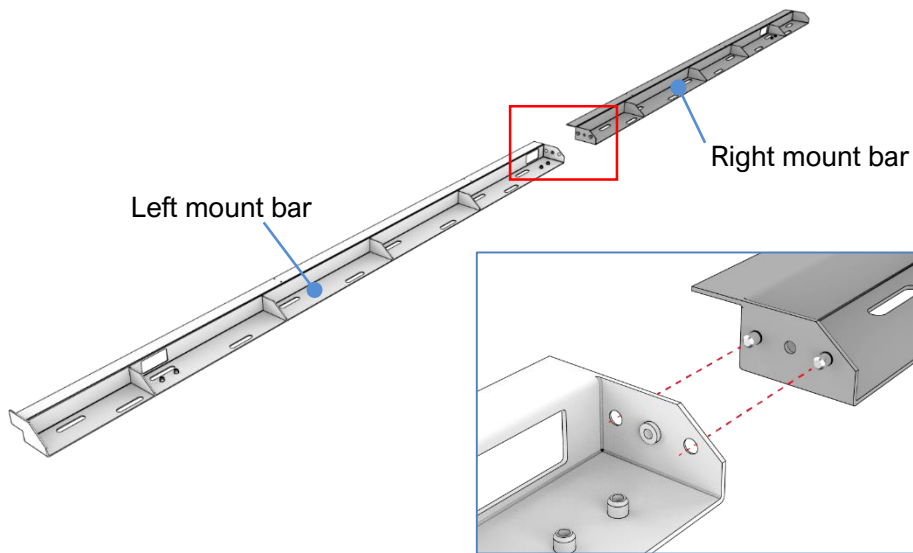

Step. 2

- Fixed assembled mount bar using M5 x 10 PHMS.
- Torque value of fastening screw: 40 kgf.cm

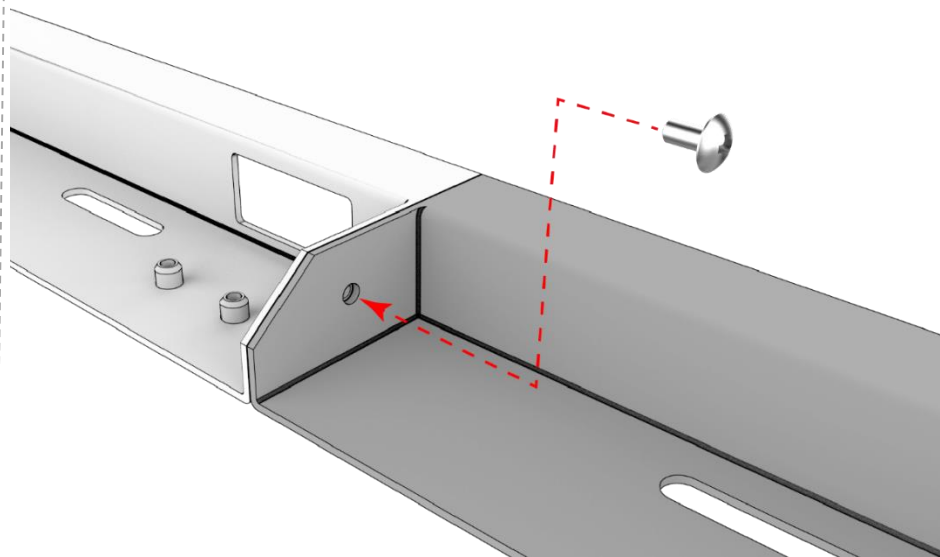

Floor Stand Assembly Instructions

Floor Stand Assembly Instructions

1. Take the vertical column module out of the shipping box

- Take out the "Vertical column module" from the transport box and let its two casters support its weight on the ground.
- Please avoid allowing the single caster of the "Vertical column module" to bear the impact of its own weight, as this may cause damage to the caster.

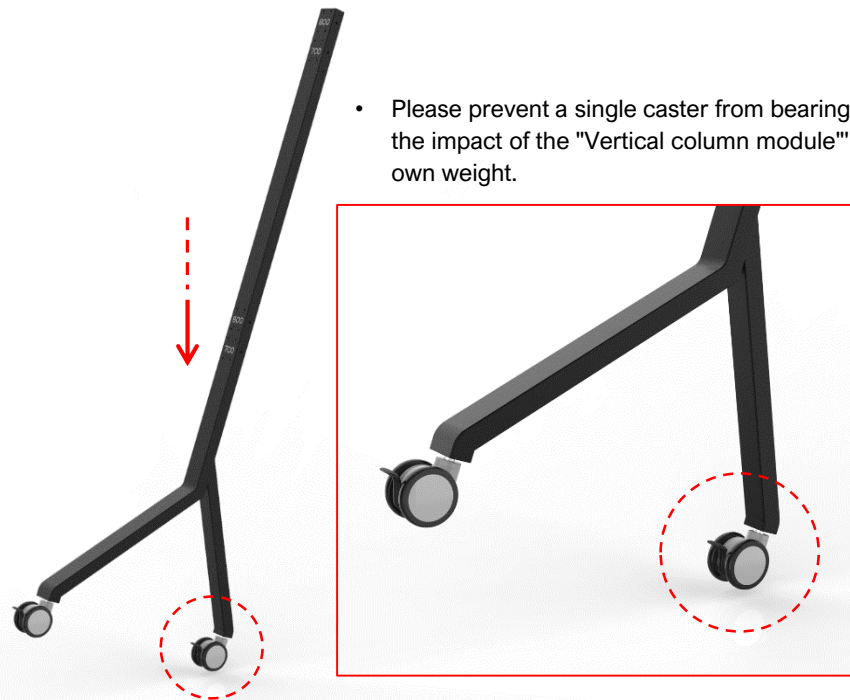

Floor Stand Assembly Instructions

2. Locking casters

Step. 1

- Rotate the four casters of the two Vertical column modules to the direction shown in the picture.

Step. 2

- Lock the four casters of two vertical column modules so they are oriented and will not slide.



Step. 2



Floor Stand Assembly Instructions

3. Set assembly plane

- FHDQ135 floor stand is stably laid flat on an elevated platform to start assembly.
- As shown in the picture, carefully place the two Vertical column modules smoothly on the elevated assembly plane.

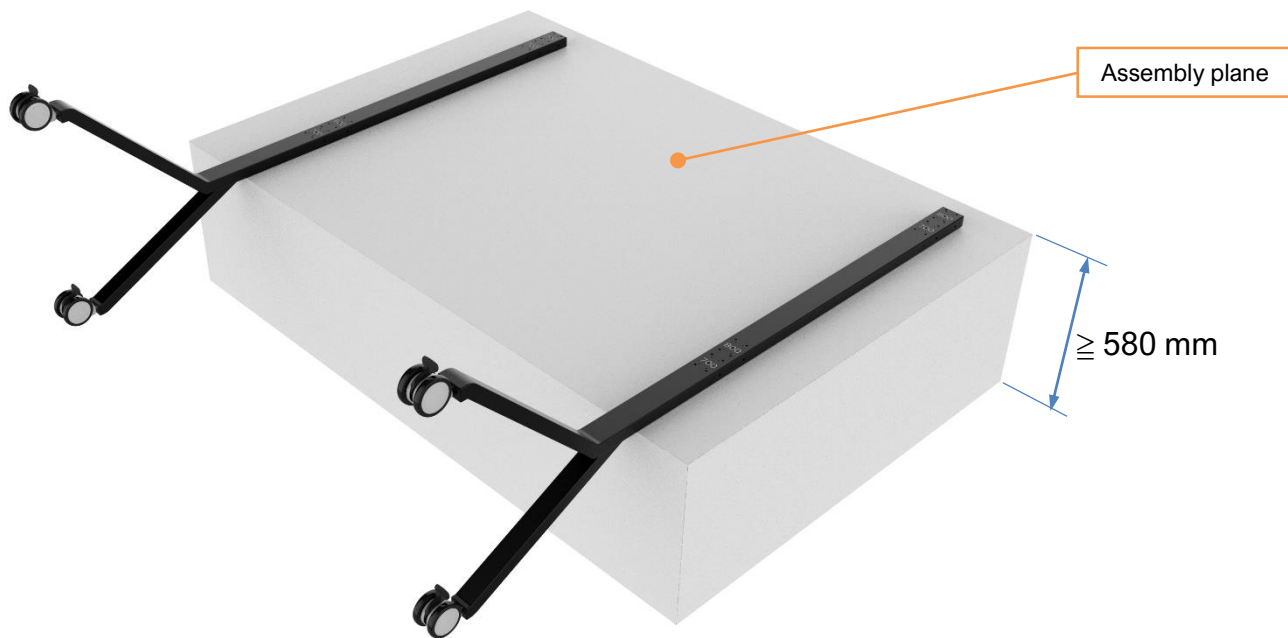

Floor Stand Assembly Instructions

4. Select the hole position of the required height to start assembly

- The FHDQ135 floor stand can hold the display at two heights, **2429mm** and **2529mm** from the ground. The following procedures show the lower rolling floor stand assembly. If mounting the desired height of **2529mm**, use the hole patterns labeled with **800** instead of **700** where appropriate.

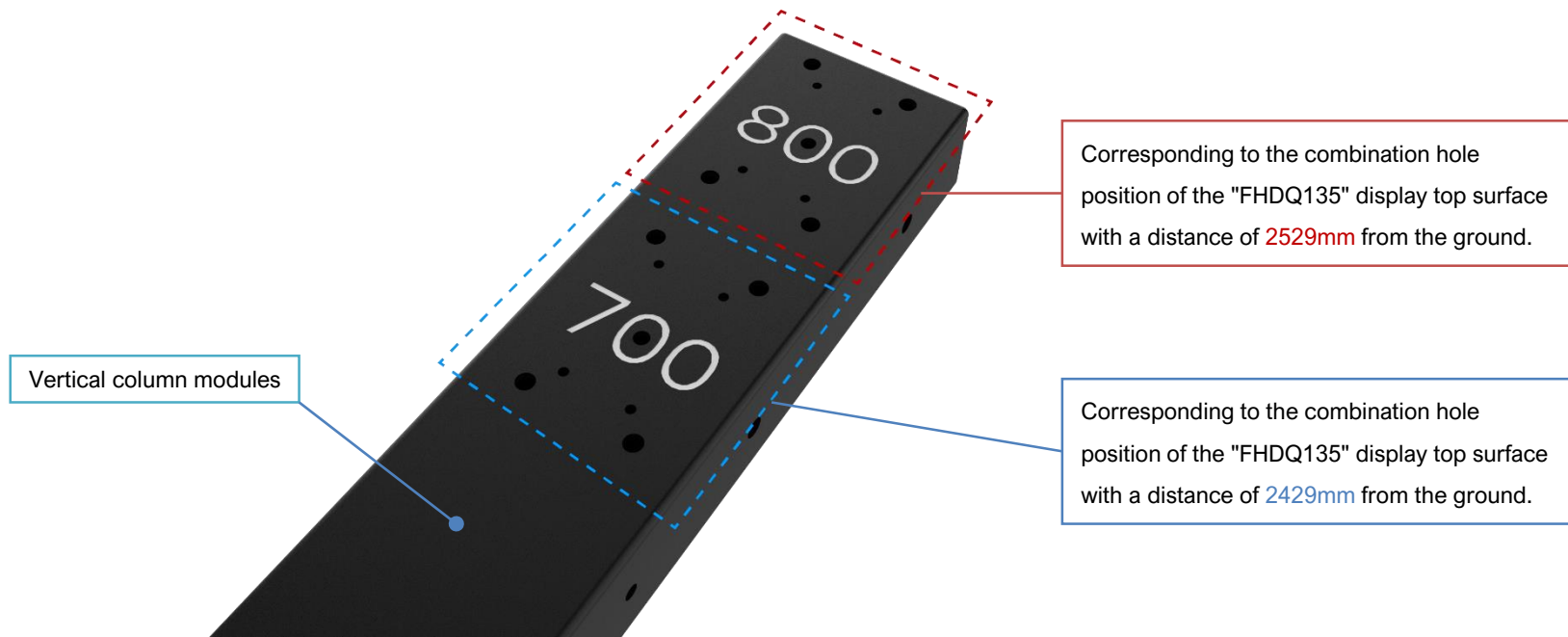

Floor Stand Assembly Instructions

5. Assemble the upper Main support beam parts

- Step 1 : make sure the arrow symbol of the Main support beam part is pointing up.
- Step 2 : Insert the positioning pin of Main support beam into the corresponding combination height positioning hole of Vertical column modules.
- Step 3: Tighten the four M4 x 10 screws as shown in the picture, the torque value is 40 kgf.cm.

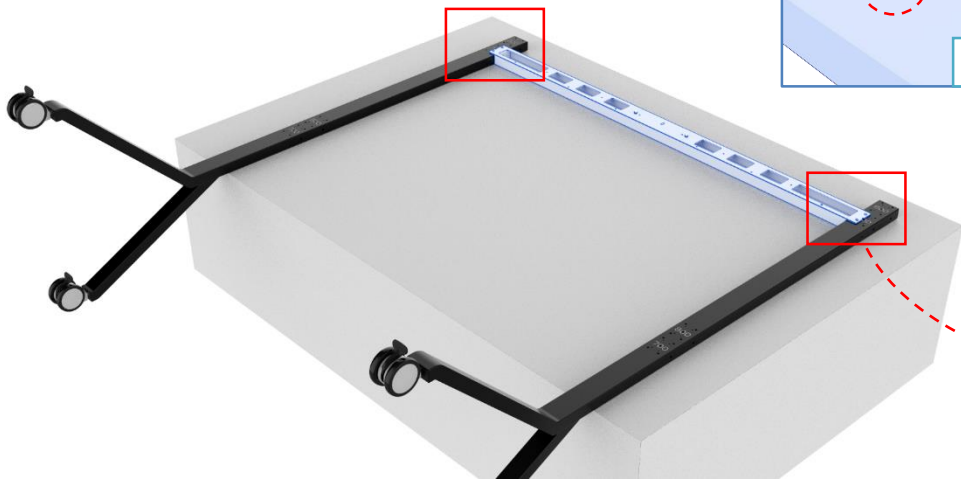
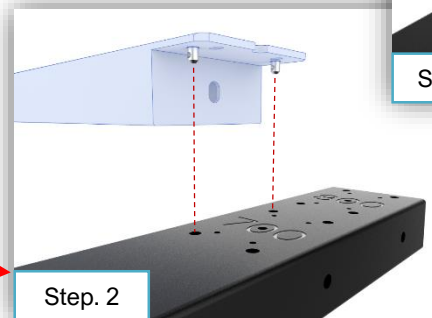
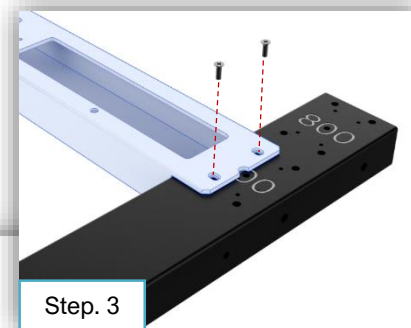
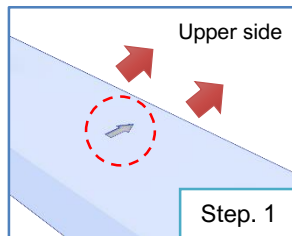

6. Assemble the lower Main support beam parts

- 
- M4 x 10 screws * 4

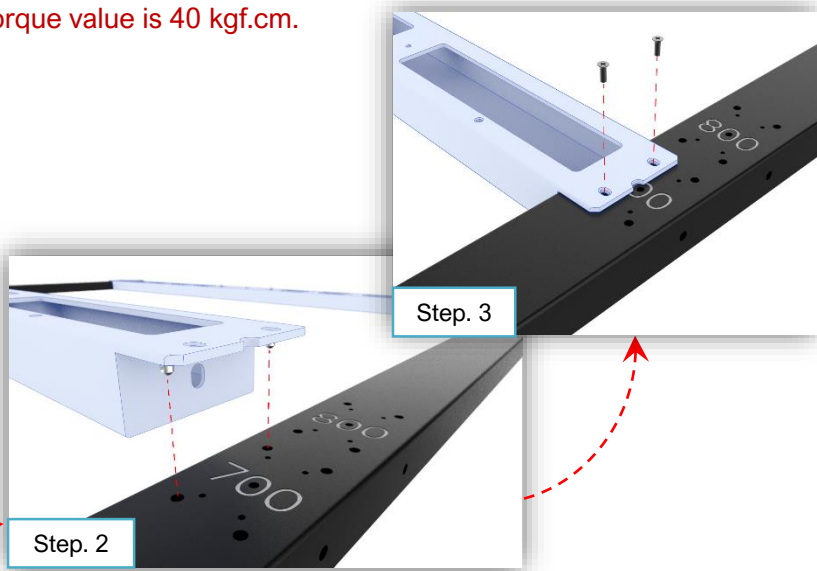
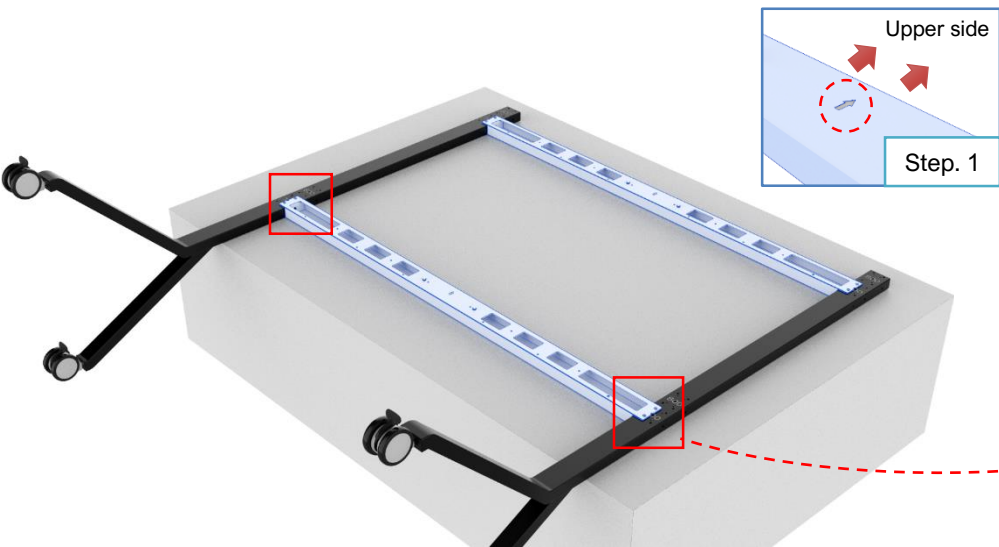

Floor Stand Assembly Instructions

7. Assembling the Right wing beam parts

- Step 1 : make sure the arrow symbol of the Right wing beam part is pointing up.
- Step 2 : As shown in the picture, insert the positioning pin of Right wing beam into the positioning hole of Vertical column modules.
- Step 3: Tighten the four M4 x 10 screws as shown in the picture, the torque value is 40 kgf.cm.

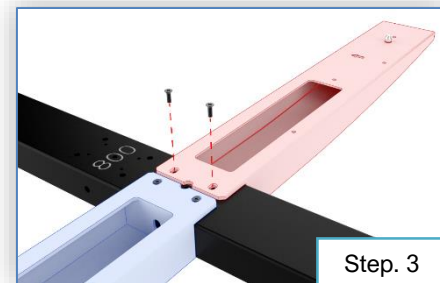
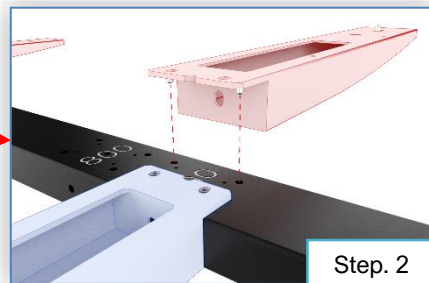
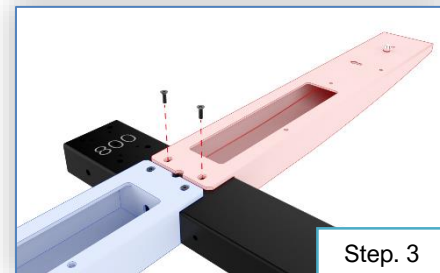
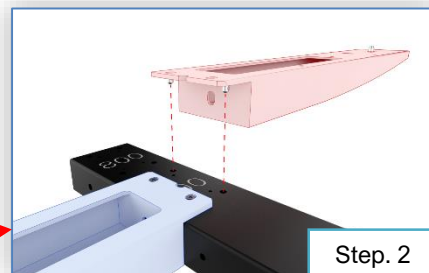
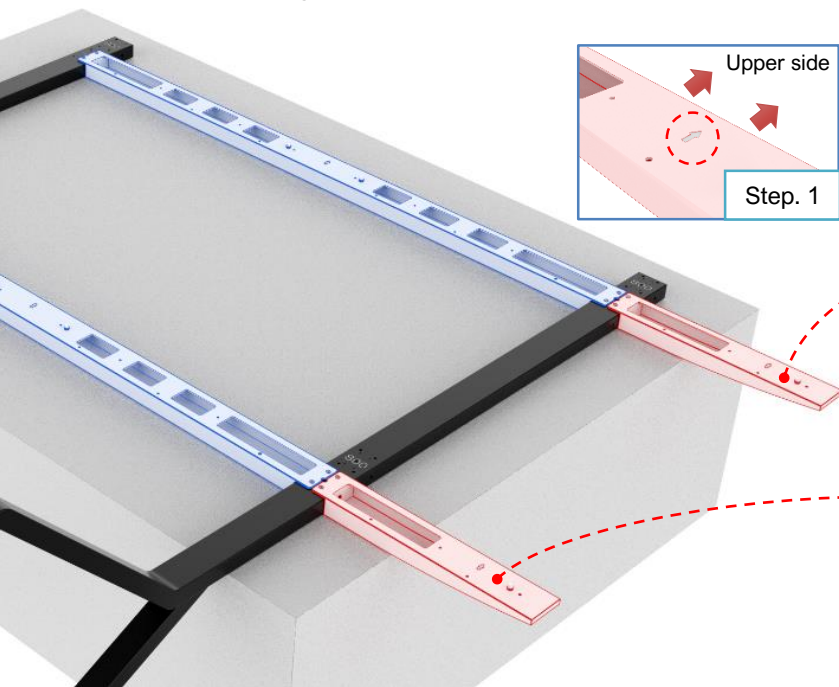

Floor Stand Assembly Instructions

8. Assembling the Left wing beam parts

- Step 1 : make sure the arrow symbol of the Left wing beam part is pointing up.
- Step 2 : As shown in the picture, insert the positioning pin of Left wing beam into the positioning hole of Vertical column modules.
- Step 3: Tighten the four M4 x 10 screws as shown in the picture, the torque value is 40 kgf.cm.

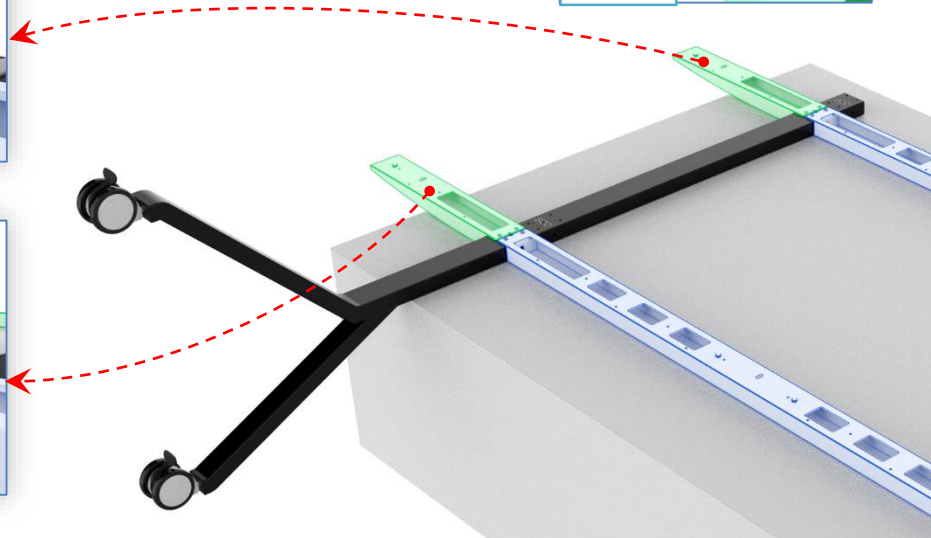
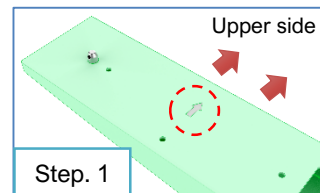
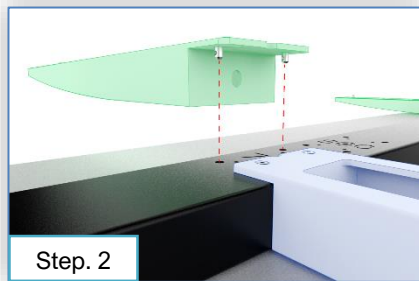
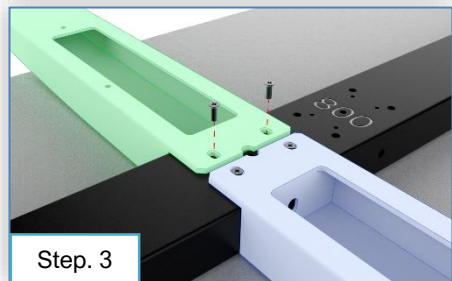
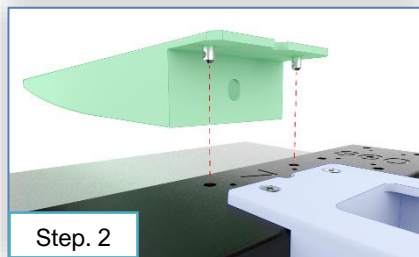
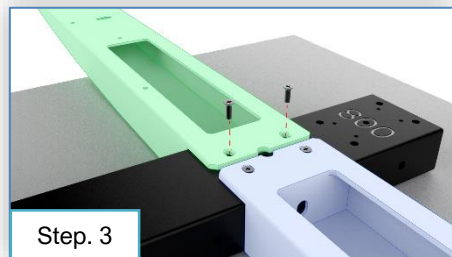

Floor Stand Assembly Instructions

9. Improve the robustness of assembled stand

- In the 8 positions shown in the figure, use **M8 x 12 SHCS w/ M8 flat washer** to firmly combine Vertical column module, Main support beam, and wing beam into one.
- **Torque value of fastening screw: 195 kgf.cm**

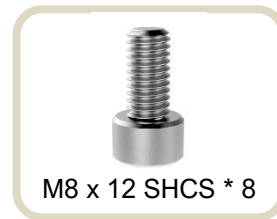

+

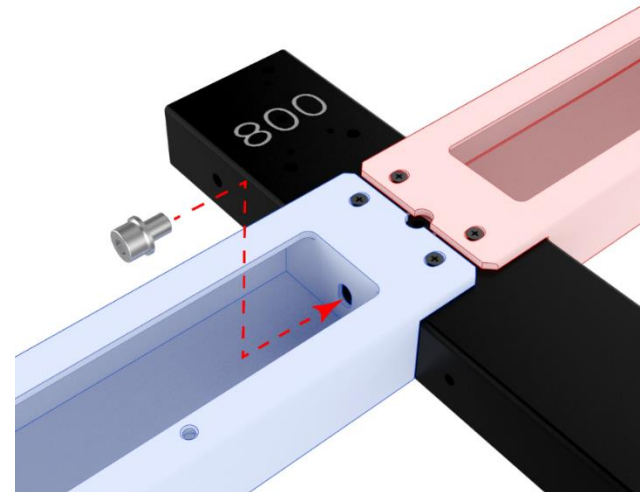
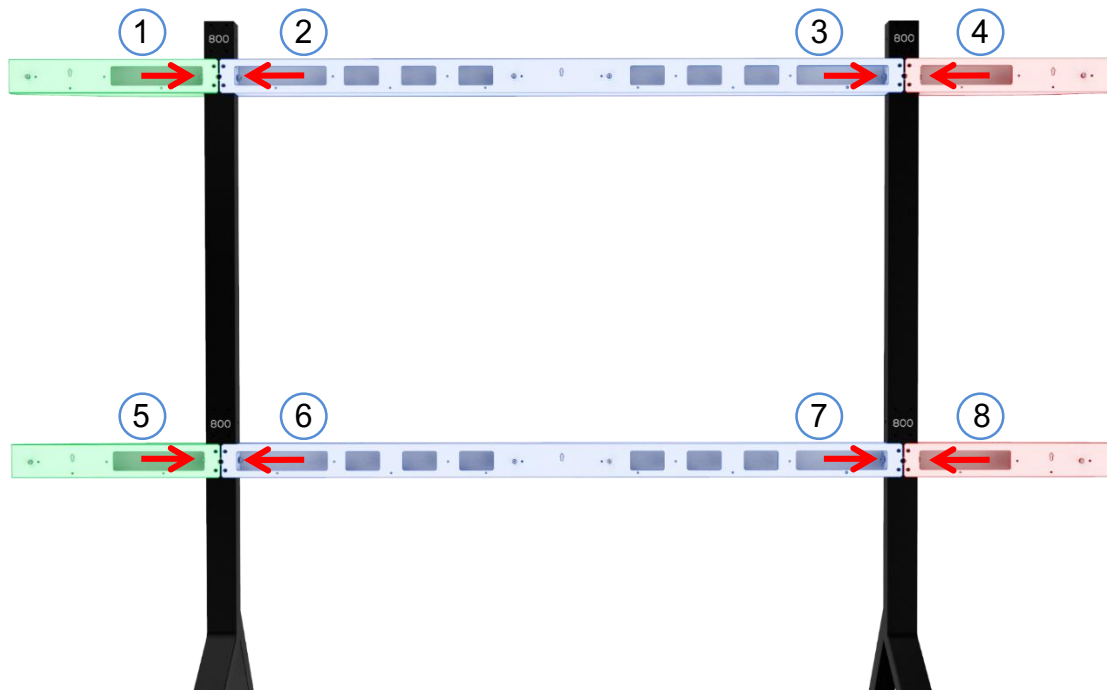

Floor Stand Assembly Instructions

10. Installing Mount Bars to Floor Stand (1/3)

- As shown in the picture, pass the positioning holes of the mount bar through the positioning pins of the floor stand beam to place it in the correct installation position.

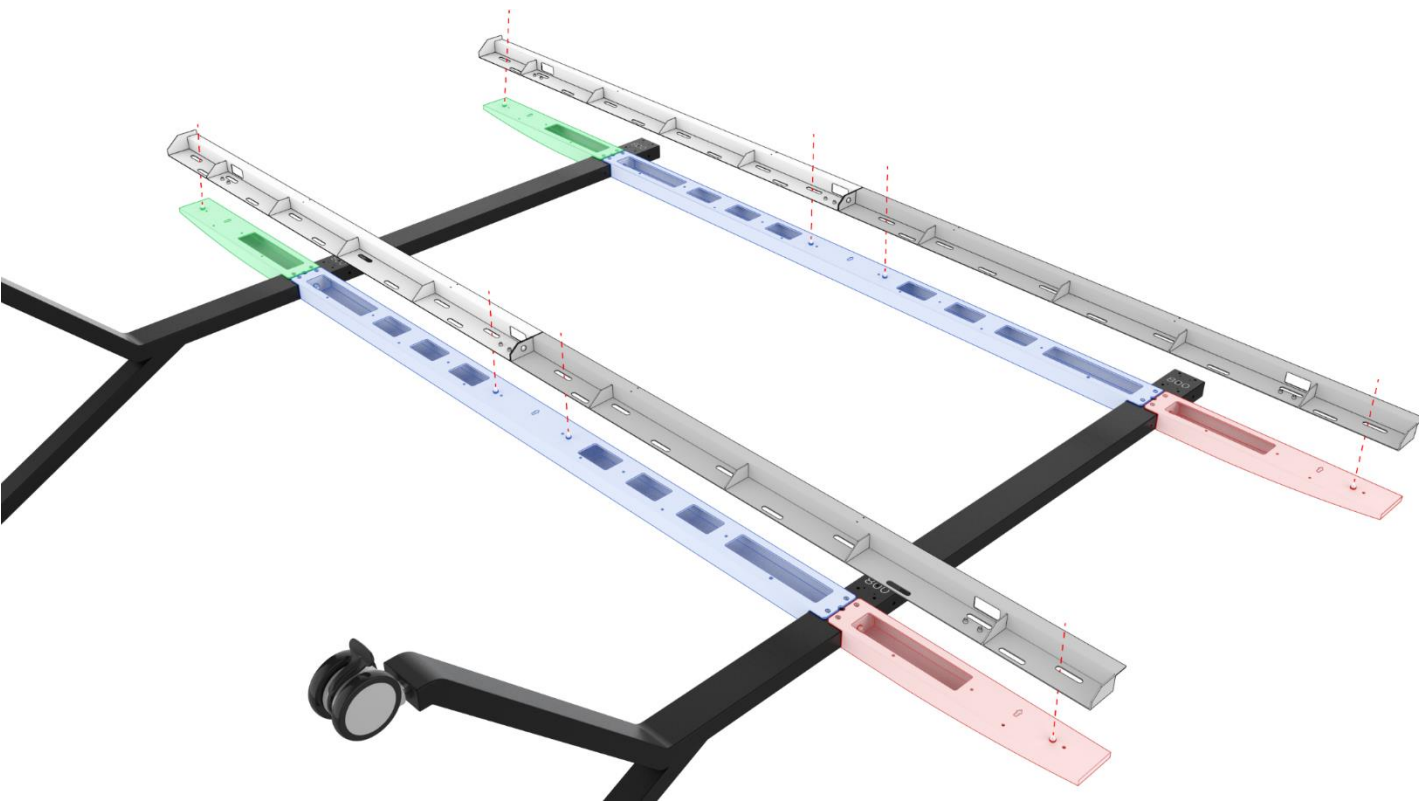

Floor Stand Assembly Instructions

10. Installing Mount Bars to Floor Stand (2/3)

- Use the beam's positioning pin to correctly limit the position and assemble the mount bars.
- As shown in the picture, slide the Mount bars that runs through the stand positioning pin to the right to the end.

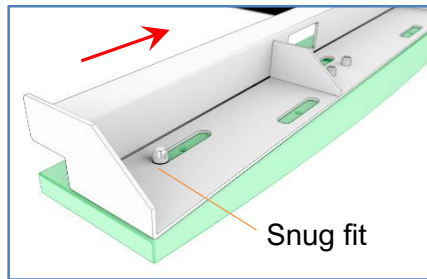
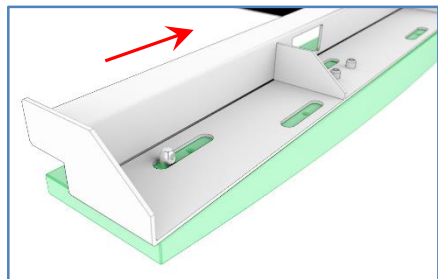
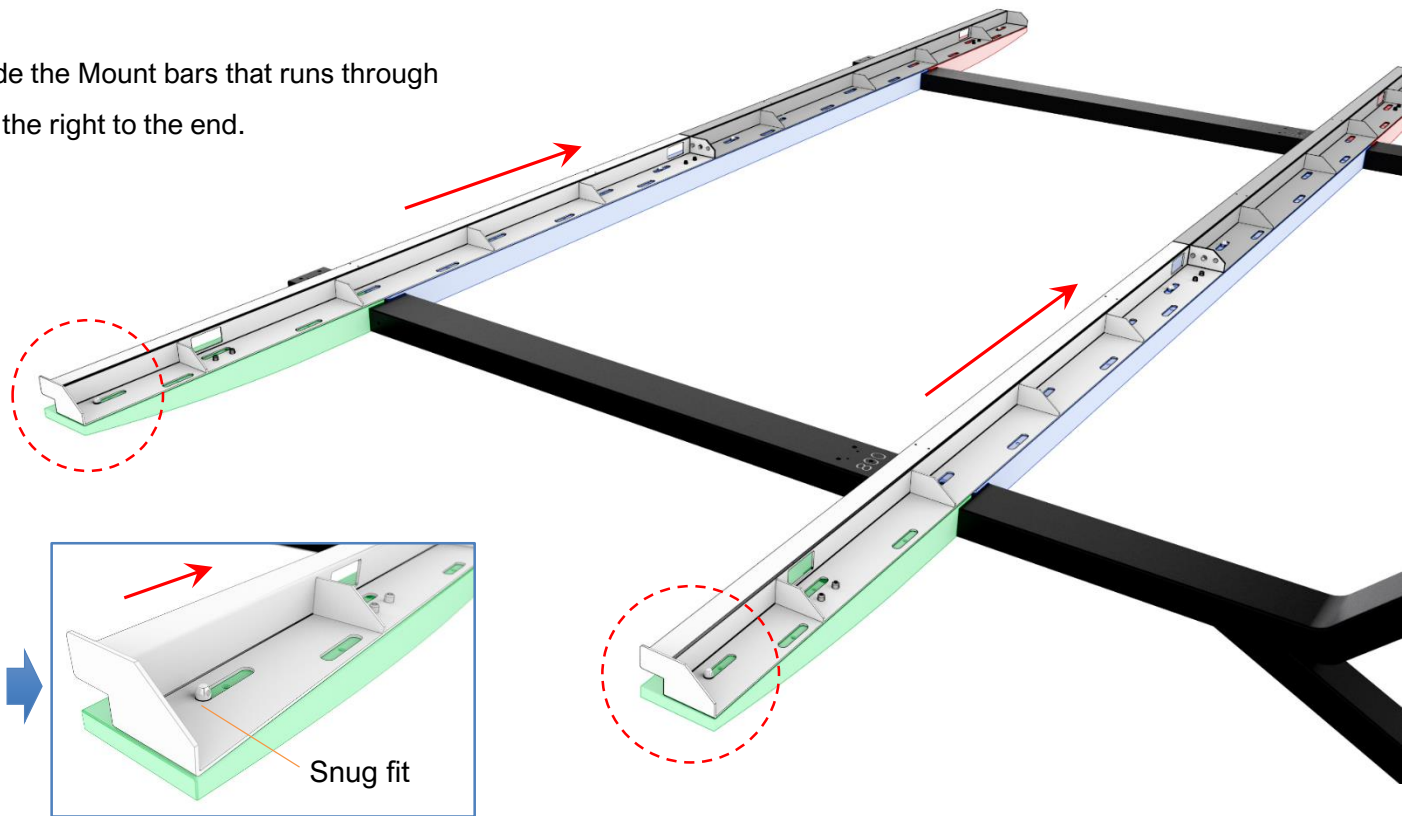

Floor Stand Assembly Instructions

10. Installing Mount Bars to Floor Stand (3/3)

- Installing 12 M6 X 20 SHCS w/ lock and flat washer plus large M6 flat washer in locations shown.
- Fastening M6 x 20 SHCS using 5 mm Allen wrench with **target torque value of 118 kgf.cm.**



+

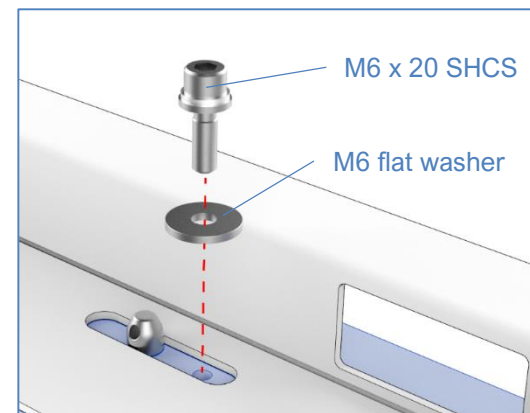
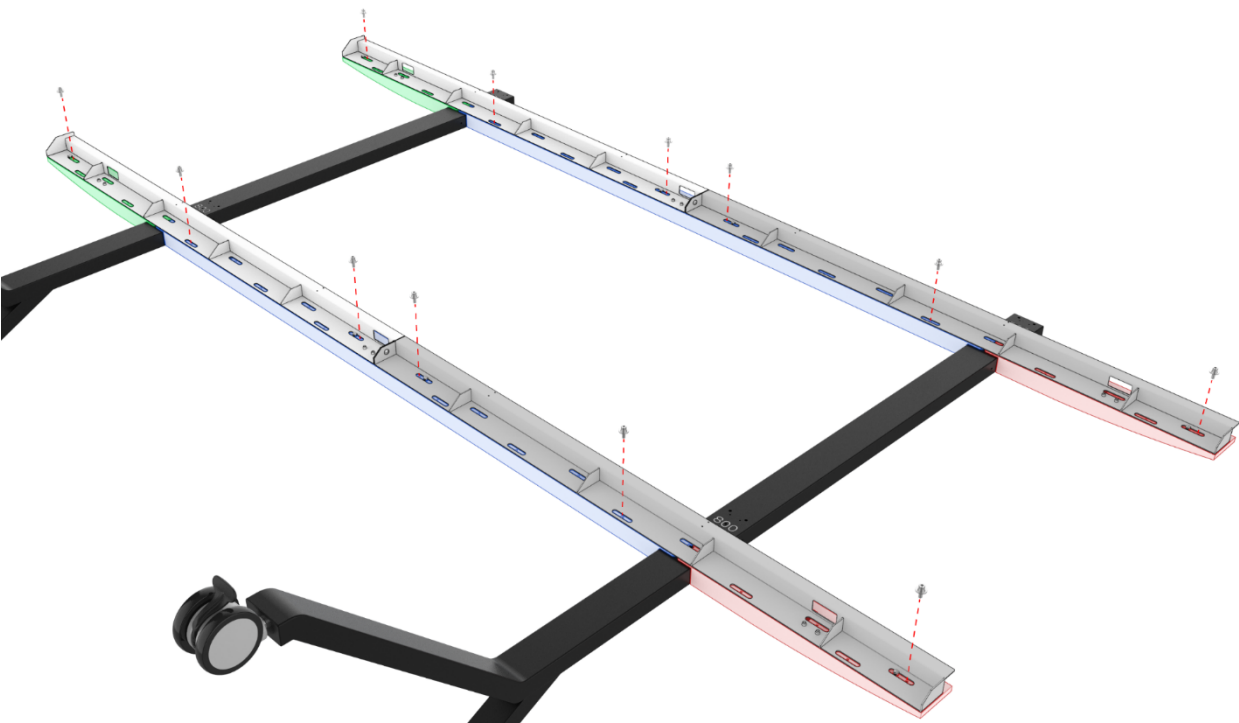

Floor Stand Assembly Completed



Thank you.

Suggestion?



Optoma